

**Site Identification**

Property Owner Swisher Bank & Trust Other ID \_\_\_\_\_

Address 59 Rose Ave. SW, Swisher IA

Tenant \_\_\_\_\_

Well Depth 280 ft Date completed 4/3/07

**Location**

County Johnson

\_\_\_\_\_ mi. <sup>N</sup> and \_\_\_\_\_ mi. <sup>E</sup> of intersection of \_\_\_\_\_ and \_\_\_\_\_  
NW 1/4 of the NW 1/4 of the NW 1/4 of Sec 8 TWP 81 RNG 7 <sup>E</sup> <sub>W</sub>

GPS Coordinates (NAD83 datum only) decimal degrees:

\_\_\_\_\_ N. Latitude \_\_\_\_\_ W. Longitude.

Show exact location of well in section grid with a dot (•). Sketch map of well location on property.

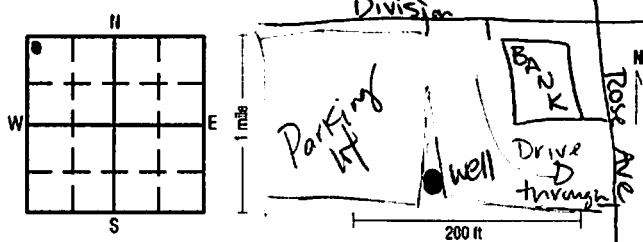

☐ upland ☐ hillside ☐ valley ☐ level surface Elevation (if known) \_\_\_\_\_

**Formation log**

From	To	Color	Hardness	Formation description
0	6	lt brown		Sandy clay
6	10	DK brown		Sandy clay
10	22	Brown		fine sand
22	75	DK gray		silty clay
75	98	gray		med. grained sand
98	123	DK gray		silty clay
123	125			coarse sand
125	137	gray		clay
137	209	whit		buff limestone
209	222	lt Brown		limestone - spring
222	229	gray		limestone
229	242			shale & limestone
242	280	lt/drk gray		limestone - Silurian

use additional sheets as needed

**Remarks** (including depth of lost drilling fluids, materials, or tools)

**Well use**

- ☐ Domestic  
☐ Livestock  
☐ Test well  
☐ Heat pump  
☐ Municipal  
☒ Public supply  
☐ Irrigation  
☐ Commercial  
☐ Monitoring  
☐ Other

**Drill method**

☒ rotary ☐ auger ☐ cable other \_\_\_\_\_

**Hole size**

10 inch from 0 ft to 48 ft  
 8 3/4 inch from 48 ft to 154 ft  
 6 inch from 154 ft to 250 ft  
 5 inch from 250 ft to 280 ft

Record all depth measurements from ground level (GL). Use (+) for above GL measurements.

**Casing**

Drive shoe (yes/no) \_\_\_\_\_ Pileless adapter (yes/no) \_\_\_\_\_

Size (ID/OD)	Type / Wt	Depth top	Depth bottom	Amount (length)
4 ID	SDR 21	+2	152	154'
4.5 ID	SDR 26	48	150	102'
liner				

**Perforated or slotted casing?** (yes/no) (no)

Perforated / slotted from \_\_\_\_\_ ft to \_\_\_\_\_ ft

Perforated / slotted from \_\_\_\_\_ ft to \_\_\_\_\_ ft

**Casing grouted?** (yes/no) (yes)

Placement method full length Haliburton

Type	Depth top	Depth bottom	Amount (vol/wt)
Bentonite	0	152	12 bags

**Well screen?** (yes/no) (no)

Diameter	Slot size	Depth top	Depth bottom	Length	Material
	0. _____				
	0. _____				

Bottom capped (yes/no) with \_\_\_\_\_  
 Seals / Packers (yes/no) kind \_\_\_\_\_ depth \_\_\_\_\_ ft  
 Gravel packed (yes/no) from \_\_\_\_\_ ft to \_\_\_\_\_ ft  
 type \_\_\_\_\_ amount \_\_\_\_\_

**Well developed?** (yes/no) (yes)

Explain airlifted  
 (pumped, airlifted, bailed) for 2 hrs at 15 GPM

**Pump installed?** (yes/no) \_\_\_\_\_

Date \_\_\_\_\_ / \_\_\_\_\_ / \_\_\_\_\_

Installer's name To Be Done by Novotny & Son

Type of pump \_\_\_\_\_ Depth to intake \_\_\_\_\_ ft

Pump diameter \_\_\_\_\_ Rated capacity \_\_\_\_\_ GPM

**Water information**

Aquifer: ☐ sand / gravel ☒ limestone ☐ sandstone

Main water-supply zone from \_\_\_\_\_ ft to \_\_\_\_\_ ft ☐ seepage well

Static water level 78 ft (below / above) GL; ☐ tape ☐ airline ☐ E-line ☒ estimate

Pumping water level 115 ft below GL; ☐ tape ☐ airline ☐ E-line ☒ estimate

At yield of 15 GPM; ☐ orifice ☐ volumetric ☒ estimate for 2 hours

Measurements taken at 12:00 (AM/PM) (PM) Date 4/3/07

**Water quality test?** (yes/no) \_\_\_\_\_

Date tested \_\_\_\_\_ / \_\_\_\_\_ / \_\_\_\_\_

Tested by To Be Done

Contractor Aquadrill, Inc.

Address 1324 Hwy 905 NW, Swisher IA 52338

Driller Matt White Certification no. 5799

STATE OF IOWA  
DEPARTMENT OF NATURAL RESOURCES  
Water Supply Section  
401 S.W. 7<sup>th</sup> St., Suite M  
DES MOINES, IOWA 50309-4611

WATER SUPPLY  
CONSTRUCTION PERMIT

Swisher Trust & Savings Bank  
Attn: Daryl Hynek  
PO Box 154  
Swisher, IA 52338

Permit No.: 2007-130W  
Project No.: W2007-018  
PWSID No.: 5285206

In accordance with the provisions of Sections 455B-173.9 and 455B-174.4, Code of Iowa, and 567 IAC 43.3 (455B) of the Iowa Administrative Code, the Director of the Department of Natural Resources does hereby issue a permit for the construction of:

Construction of a new water supply Well #3 (20 gpm, 6-inch casing to 150 feet, total depth of well is 250 feet deep) including all related and necessary appurtenances included in the plans and specifications, to replace old well at Swisher Trust & Savings Bank located in Swisher, Iowa.

This permit is granted based on the following conditions:

1) The well contractor include the PWSID # 5285206 (WL03), as part of the identification information, when submitting the water quality test sample bottles to the certified lab for analysis.

2) Bentonite grout shall consist of at least 20% solids.

NOTICE: The issuance of this construction permit is based SOLELY on the engineer's certification that all aspects of design included in the project meet the requirements of all applicable state and federal laws and regulations. An advisory review of the plans and specifications may be made at a later date.

The construction of the project shall be initiated within one year of issuance of this permit or this permit is no longer valid. Within thirty days after completion of construction, the permit holder shall submit a certification by a registered professional engineer that the project was completed in accordance with the approved project documents.

Pursuant to Section 455B.174.4, Code of Iowa, you have the right to appeal any condition of this permit by filing with the Director of the Department of Natural Resources a notice of appeal and request for administrative hearing within thirty days of receipt of this permit.

If you have any questions, contact Mark T. Moeller at 515/725-0292 or by e-mail at [mark.moeller@dnr.state.ia.us](mailto:mark.moeller@dnr.state.ia.us).

For the Department of Natural Resources

Jeffrey R. Vonk, Director

By:

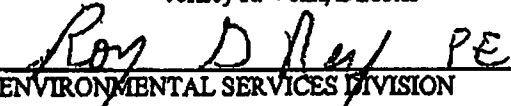
 PE  
ENVIRONMENTAL SERVICES DIVISION

Date:

January 2, 2007

cc Iowa Geological Survey, Attn: Chad Fields; 109 Trowbridge Hall, Iowa City, IA 52242-1319  
MMS Consultants Inc.; Attn: Neil Shatek; 1917 South Gilbert; Iowa City, IA 52240  
Field Office #6, Washington  
File: PWSID#: 5285206