

Site identification

Property Owner Rembrandt Enterprise Inc Well Number 2  
Address Blacktop C2S-1 mile east of HWY 71  
Tenant None  
Well Depth 426 ft Date completed 7 / 30 / 01

Location

County Buena Vista

700' N and 1 m E intersection of HWY 71 and C2S  
SW 1/4 of the SW 1/4 of the SW 1/4 of Sec. 32 WP 93 Rng 36 E

Show exact location of well in section grid with a dot (•). Sketch map of well location on property.

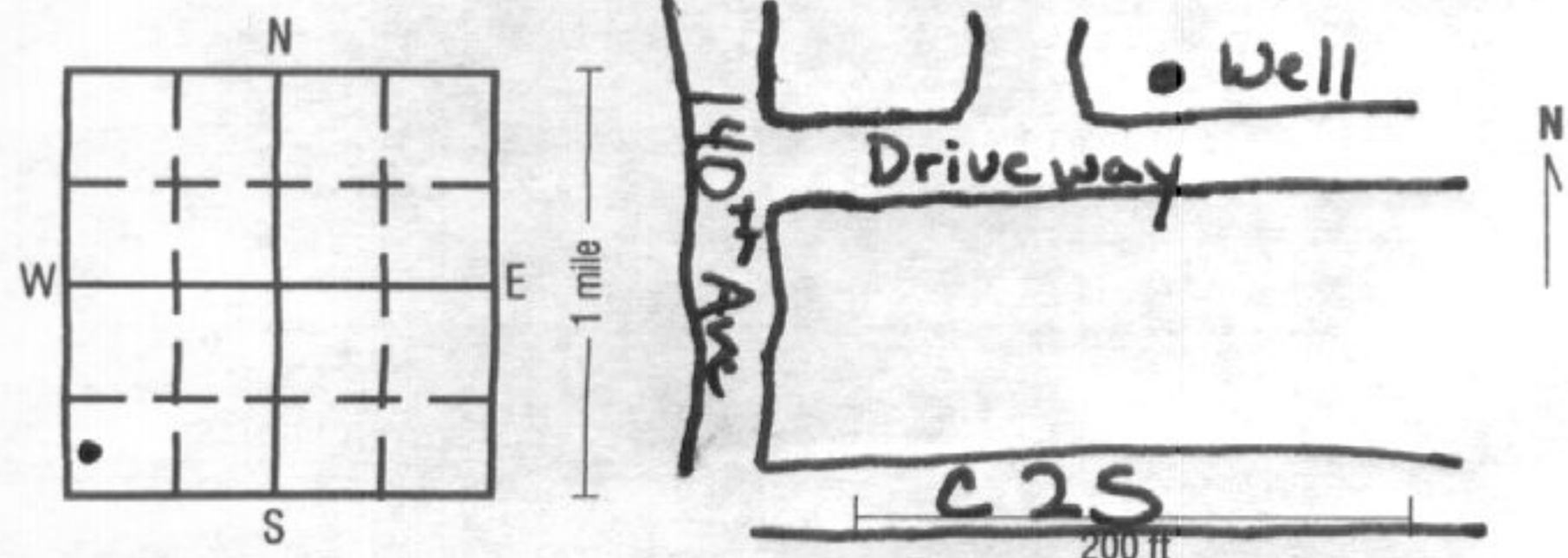

☐ upland ☐ hillside ☐ valley Elevation (if known) \_\_\_\_\_

Formation log

From	To	Color	Hardness	Formation description
0	2			Topsoil
2	16			Yellow Clay
16	42			Blue Clay
42	53			Yellow Clay
53	77			Blue Clay
77	107			Greenish-Blue Clay
107	138			Yellow Clay
138	157			Blue Clay
157	218			Blue Shale
218	265			Sandy Shale
265	268			Brown Shale
268	287			White Shale
287	294			Gray Shale
294	351			Fine Sandstone
351	359			Dirty-Sandstone
359	385			Sandstone
385	426			Best Sandstone
427				Shale-Stripes

Remarks (including depth of lost drilling fluids, materials, or tools)

Well use

- ☐ Domestic ☐ Municipal ☐ Commercial  
☒ Livestock ☐ Public supply ☐ Monitoring  
☐ Test well ☐ Irrigation ☐ Other \_\_\_\_\_ (explain)

Drill method

☒ rotary ☐ auger ☐ cable other \_\_\_\_\_

Hole size

13 inch from 0 ft to 390 ft  
8 inch from 390 ft to 426 ft

Record all depth measurements from ground level (GL). Use (+) for above GL measurements.

Casing

Drive shoe ☒ (yes/no) Pitless adapter ☒ (yes/no)

Size (ID/OD)	Type / Wt	Depth top	Depth bottom	Amount (length)
8" ID	Steel/30*	1'	389	390'
5" ID	PVC/200*	370'	390	20'

Perforated or slotted casing? (yes/no)

Perforated / slotted from \_\_\_\_\_ ft to \_\_\_\_\_ ft  
Perforated / slotted from \_\_\_\_\_ ft to \_\_\_\_\_ ft

Casing grouted? (yes/no)

Placement method Trimme

Type	Depth Top	Depth bottom	Amount (vol/wt)
Bentonite	Surface	320'	1000' gallons

Well screen? (yes/no)

Diameter	Slot size	Depth Top	Depth Bottom	Length	Material
5" tele	0.018	390	426	36'	Stainless Steel

Bottom capped? (yes/no)

with Bail Bottom

Seals / Packers (yes/no)

kind \_\_\_\_\_ depth \_\_\_\_\_ ft

Gravel packed? (yes/no)

from 370 ft to 426 ft  
type 16/30 silica amount 1400 #

Well developed? (yes/no)

Explain Bailed & Pumped

(pumped, airlifted, bailed) for 3 hrs at 270 GPM.

Pump installed? (yes/no)

Date \_\_\_\_\_ / \_\_\_\_\_ / \_\_\_\_\_

Installer's name \_\_\_\_\_

Type of pump \_\_\_\_\_ Depth to intake \_\_\_\_\_ ft

Pump diameter \_\_\_\_\_ Rated capacity \_\_\_\_\_ GPM

Water information

Aquifer: ☐ sand / gravel ☐ limestone ☒ sandstone

Main water-supply zone from 390 ft to 426 ft ☐ seepage well

Static water level 128 ft (below/above) GL; ☐ tape ☐ airline ☒ E-line ☐ estimate

Pumping water level 160 ft below GL; ☐ tape ☐ airline ☒ E-line ☐ estimate

At yield of 270 GPM; ☐ orifice ☒ volumetric ☐ estimate

Measurements taken at 2:30 (AM/PM) Date 7 / 30 / 01

Water quality test? (yes/no)

Date tested 7 / 30 / 01

Tested by Margold Environmental Testing

Contractor Middle Jeff Well Co

Address Sioux Rapids, IA

Driller Larry Steece Certification no. 40492