

WELL RECORD

Iowa Department of Natural Resources Geological Survey Bureau  
109 Trowbridge Hall Iowa City, Ia. 52242-1319 PH (319) 335-1575

PWTS Well No.: \_\_\_\_\_

PWTS Permit No. \_\_\_\_\_  
County Permit No. 2018-0493W

**Site Identification**  
Property Owner PALISADES-KEPLER STATE PARK ID: \_\_\_\_\_  
Address 700 KEPLER DRIVE, MOUNT VERNON, IA 52314  
Tenant \_\_\_\_\_  
Well Depth: 440 ft Date Completed: 9/21/2018

**Location** County LINN COUNTY IOWA  
\_\_\_\_ mi.<sup>N</sup><sub>S</sub> and \_\_\_\_ mi.<sup>E</sup><sub>W</sub> of intersection of \_\_\_\_\_ and \_\_\_\_\_  
SW 1/4 of the NW 1/4 of the SE 1/4 of Sec 13 TW 82N RN 6W <sup>E</sup><sub>W</sub>  
GPS Coordinates (NAD83 datum only) decimal degrees:  
41.910983 N. Latitude -91.503917 W. Longitude

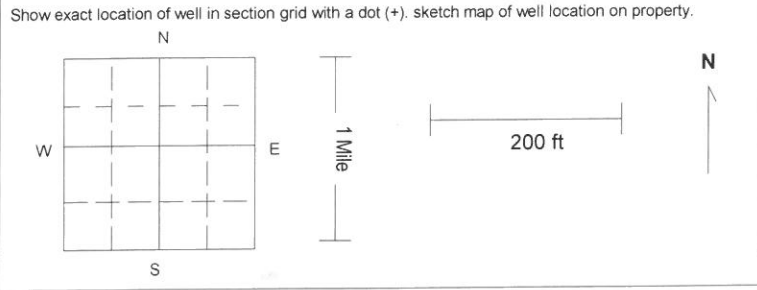

Upland  Hillside  Valley  Level Surface Elevation (if known) \_\_\_\_\_

**Formation Log**

From	To	Color	Hardness	Formation Description
0	80	BROWN		CLAY
80	105	BLUE		CLAY
105	130	YELLOW		LIMESTONE
130	131	YELLOW		SHALE
131	150	YELLOW		LIMESTONE
150	180	YELLOW		LIMESTONE, SHALE MIX
180	233	YELLOW		LIMESTONE
223	225	YELLOW		SHALE
225	243	YELLOW		LIMESTONE
243	248	GRAY		LIMESTONE, SHALE MIX
248	300	YELLOW		LIMESTONE
300	310	WHT/GRY		LIMESTONE
310	375	GRAY		LIMESTONE
375	438	TAN		LIMESTONE
<u>438 440 Green shale</u>				

**Remarks** (including depth of lost drilling fluids, materials, or tools)  
\_\_\_\_\_

**Well Use**

<input type="checkbox"/> Domestic	<input type="checkbox"/> Heat Pump	<input type="checkbox"/> Commercial
<input type="checkbox"/> Livestock	<input type="checkbox"/> Municipal	<input type="checkbox"/> Monitoring
<input type="checkbox"/> Test Well	<input checked="" type="checkbox"/> Public Supply	<input type="checkbox"/> Other _____
	<input type="checkbox"/> Irrigation	

**Drill Method**  rotary  auger  cable other \_\_\_\_\_  
**Hole Size**  
16 inch fro 0 ft to 108 ft 7 7/8 inch from 255 ft to 440 ft  
13 inch fro 108 ft to 255 ft \_\_\_\_\_ inch from \_\_\_\_\_ ft to \_\_\_\_\_ ft

**Casing** Placement Method: HALLIBURTON  Drive shoe  Plu

Size (ID/OD)	Type/Wt	Depth top	Depth bottom	Amount (length)
8.625 OD	STEEL SCH40/.322	+2	255	257

**Perforated or Slotted Casing**

<input type="checkbox"/> Perforated	<input type="checkbox"/> Slotted	from _____	ft to _____	ft
<input type="checkbox"/> Perforated	<input type="checkbox"/> Slotted	from _____	ft to _____	ft

**Casing Grouted**  Grouted

Type	Depth top	Depth bottom	Amount (vol/wt)
NEAT CEMENT	0	255	155 BAGS

**Well Screen**  Screen

Diameter	Slot size	Depth top	Depth bottom	Length	Material

Bottom Capped  with \_\_\_\_\_  
Packers  kind \_\_\_\_\_ depth \_\_\_\_\_ ft  
Seals  kind \_\_\_\_\_ depth \_\_\_\_\_  
Gravel packed  from \_\_\_\_\_ to \_\_\_\_\_ ft  
type \_\_\_\_\_ amount \_\_\_\_\_

**Well Developed**  Well Developed  
Explain WITH AIR  
 pumped  airlifted  bailed for 24 hrs at 70 GPM

**Pump Installed**  Pump Installed Date \_\_\_\_\_  
Type of Pump \_\_\_\_\_ Depth to Intake \_\_\_\_\_ ft  
Pump diameter \_\_\_\_\_ Rated Capacity \_\_\_\_\_ GPM

**Water information**  Sand/gravel  Limestone  Sandstone  
Main Water-Supply Zone 1 from 300 ft to 400 ft  Seepage Well  
Main Water-Supply Zone 2 from \_\_\_\_\_ ft to \_\_\_\_\_ ft  
Static water level 162 ft (below/above) GL  tape  airline  E-line  estimate  
Pump water level 281 ft (below )GL;  tape  airline  E-line  estimate  
At yield of 70 GPM  Orifice  Volumetric  Estimate for 24 hours  
Measurement taken at \_\_\_\_\_ Date 9/21/2018

**Water quality test?**  Date \_\_\_\_\_  
Tested by Hygenic Lab

Contractor Name GINGERICH WELL PUMP SERVICE, LLC  
Address 1331 HWY 1, KALONA, IA 52247  
Driller DILLON GINGERICH Certification No. 1017