

# WELL RECORD

95918

Iowa Department of Natural Resources Geological Survey Bureau  
109 Trowbridge Hall Iowa City, Ia. 52242-1319 PH (319) 335-1575

PWTS Well No.:

PWTS Permit No.

County Permit No.

## Site Identification

Property Owner ANAMOSA, CITY OF ID: WELL #6

Address 1XXX WILLIAMS ST, ANAMOSA, IA 52205

Tenant

Well Depth: 1651 ft Date Completed: 12/16/2021

Location County JONES COUNTY IOWA

     mi.<sup>N</sup><sub>S</sub> and      mi.<sup>E</sup><sub>W</sub> of intersection of      and     

1/4 of the 1/4 of the 1/4 of Sec 2 TW 84N RN 4W E W

GPS Coordinates (NAD83 datum only) decimal degrees:

N. Latitude

W. Longitude

Show exact location of well in section grid with a dot (+). sketch map of well location on property.

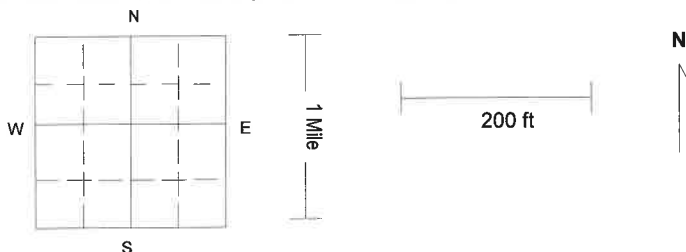

☒ Upland ☐ Hillside ☐ Valley ☐ Level Surface Elevation (if known)     

## Formation Log

From	To	Color	Hardness	Formation Description
				**SEE ATTACHED FORMATIONS**

LAT 42.118711°

LONG -91.279771°

ELE 931

Remarks (including depth of lost drilling fluids, materials, or tools)

ADDITIONAL DRILLER: DILLON GINGERICH 10177

## Well Use

☐ Domestic

☐ Livestock

☐ Test Well

☐ Heat Pump

☐ Municipal

☒ Public Supply

☐ Irrigation

☐ Commercial

☐ Monitoring

☐ Other

Drill Method ☒ rotary ☐ auger ☐ cable ☐ other

## Hole Size

32 inch from 0 ft to 178 ft 14.75 inch from 1160 ft to 1651 ft  
23 inch from 178 ft to 1160 ft inch from ft to ft

Casing Placement Method: TRIMIE/INNERSTRING ☒ Drive shoe ☐ Plu

Size (ID/OD)	Type/Wt	Depth top	Depth bottom	Amount (length)
26 OD	STEEL .500	0	178	178
16 OD	STEEL .500	+1	1160	1161

## Perforated or Slotted Casing

☐ Perforated ☐ Slotted from ft to ft  
☐ Perforated ☐ Slotted from ft to ft

Casing Grouted ☒ Grouted

Type	Depth top	Depth bottom	Amount (vol/wt)
NEAT CEMENT	0	178	360 CU/FT
NEAT CEMENT	0	1160	2121 CU/FT

Well Screen ☐ Screen

Diameter	Slot size	Depth top	Depth bottom	Length	Material

Bottom Capped ☐ with  
Packers ☐ kind depth ft  
Seals ☐ kind depth  
Gravel packed ☐ from to ft  
type amount

Well Developed ☒ Well Developed

Explain WITH AIR/AIR SURGE

☐ pumped ☒ airlifted ☐ bailed for 8 hrs at 800 GPM

Pump Installed ☐ Pump Installed Date

Type of Pump Depth to Intake ft  
Pump diameter Rated Capacity GPM

Water information ☐ Sand/gravel ☐ Limestone ☒ Sandstone  
Main Water-Supply Zone 1 from 1445 ft to 1470 ft ☐ Seepage Well  
Main Water-Supply Zone 2 from ft to ft

Static water level 435 ft (below/above) GL ☒ tape ☐ airline ☐ E-line ☐ estimate  
Pump water level ft (below) GL; ☐ tape ☐ airline ☐ E-line ☐ estimate

At yield of 800 GPM ☐ Orifice ☐ Volumetric ☒ Estimate for 8 hours  
Measurement taken at 4:00:00 PM Date 12/16/2021

Water quality test? ☐ Date

Tested by

Contractor Name GINGERICH WELL PUMP SERVICE, LLC

Address 1331 HWY 1, KALONA, IA 52247

Driller KLINT GINGERICH

Certification No. 2639

City of Anamosa			
Well #6			
From	To	Color	Formation Description
0	43		Clay
43	60	Blue	Clay & Sand Mix
60	73	Blue	Clay
73	78		Sand & Gravel
78	159	Blue	Clay
159	340	Yellow/Tan	Limestone
340	390	Gray	Limestone
390	430	Gray	Very Porous Limestone
430	550	Tan	Limestone
550	570	Gray	Shale & Limestone Mix
570	680	Gray	Shale
680	1040	Brown	Limestone
1040	1110	White	Sandstone
1110	1150	Light Tan	Limestone
1150	1435	Tan/Pink/Brown	Limestone
1435	1450	Tan/White	Sandstone & Limestone
1450	1460	White	Sandstone
1460	1550	Tan/White	Sandstone & Limestone
1550	1651	Tan/Brown	Limestone